



The Knight's Tablet

"Put on the armor of God and fight the good fight of faith." – St. Paul

August 14, 2024



Good Afternoon,

Welcome back to another school year! At St. Paul School we will strive to **Be the Light** for all to see the God's love! Every Wednesday we will be sending out **The Knight's Tablet**, our school newsletter. Please look for important information, upcoming events, and the lunch menu. If you have not logged into TeachrEase please do so ASAP. Thank you!

Blessings to all,

School News/Reminders:



*Donate Supplies
from our*

 **wishlist**

[Click Here](#)

Please join us for a monthly family rosary led by children on Tuesday, September 3. Doors open at 6:30PM. Rosary begins at 6:45 PM. All are welcome!



Upcoming Events

- Aug 20~** St. Paul PTO Meeting
- Aug 27~** Back to School Night K-8, Parents Only, 6:30pm in the gym
- Sept. 1~** Parish Picnic
- Sept. 2 ~** Labor Day– **NO SCHOOL**
- Sept. 6 ~**Faculty Meeting–**NOON DISMISSAL**

Servers Schedule

- Aug 15** D. Ferranto & K. O'Connor
- Aug 16** D. Ferranto & K. O'Connor
- Aug. 17** 4:30 PM VOLUNTEERS NEEDED
- Aug. 18** 7:00AM C. Hall, C. Hoff
9:00 AM M. & C. Lanham
11:00 AM K. Lickteig & N. Loy

NEW DISMISSAL PROCEDURES- PLEASE READ CAREFULLY.

Pre-Kindergarten/Kindergarten/First Grade (If the youngest rider is in PK or grade 1)-Enter by Parish Center drive line up in the SCHOOL PARKING LOT in THREE rows facing Church Road. Please pull up to the car in front of you and put your car in “park”. If you are the first to arrive you will need to pull up to the end of the lot.
****NOTE:** If you need to turn right out of the school parking lot (toward the K.C. Hall) please be sure to get in the line closest to the school. Otherwise, all lines will be turning left out of the school parking lot. **ONCE THE LOT IS SECURED YOU WILL NEED TO PICK YOUR CHILD UP FROM THE SAFETY AREA/SQUARE AND WALK DIRECTLY TO YOUR CAR AND BUCKLE UP!!** The lot will not be dismissed until all children are in their vehicle.

2nd through 8th grade students in car/ carpool – Enter the parking lot on Church Road drive between the cemetery and the church drive all the way around and line up in the CHURCH PARKING LOT directly across from the school AND in the GRAVEL PARKING LOT. If you park on the black top you need to face Church Road. No one is to leave by the south side (cemetery side) of the church. Parents parking in the gravel lot **MUST** face north (toward the K.C. Hall) and **MUST** dismiss in that direction. You may not go south out of the gravel lot. **PLEASE** do not leave the gravel lot until cones are removed for you to exit. We will only be dismissing from **ONE** gravel lot exit. (please see the diagram)

LATE ARRIVALS If you arrive late, please park in the Quilters Lot (by the ballpark) or the KC lot and wait for the school lot to be reopened. Once the cones are removed you may enter the school lot for late pick up. (Parish Center Drive)

It is important to follow the guidelines of the parking lot for both the safety of the children and the fairness to those who are following the guidelines. **SAFETY IS OUR MAIN FOCUS!!!!**

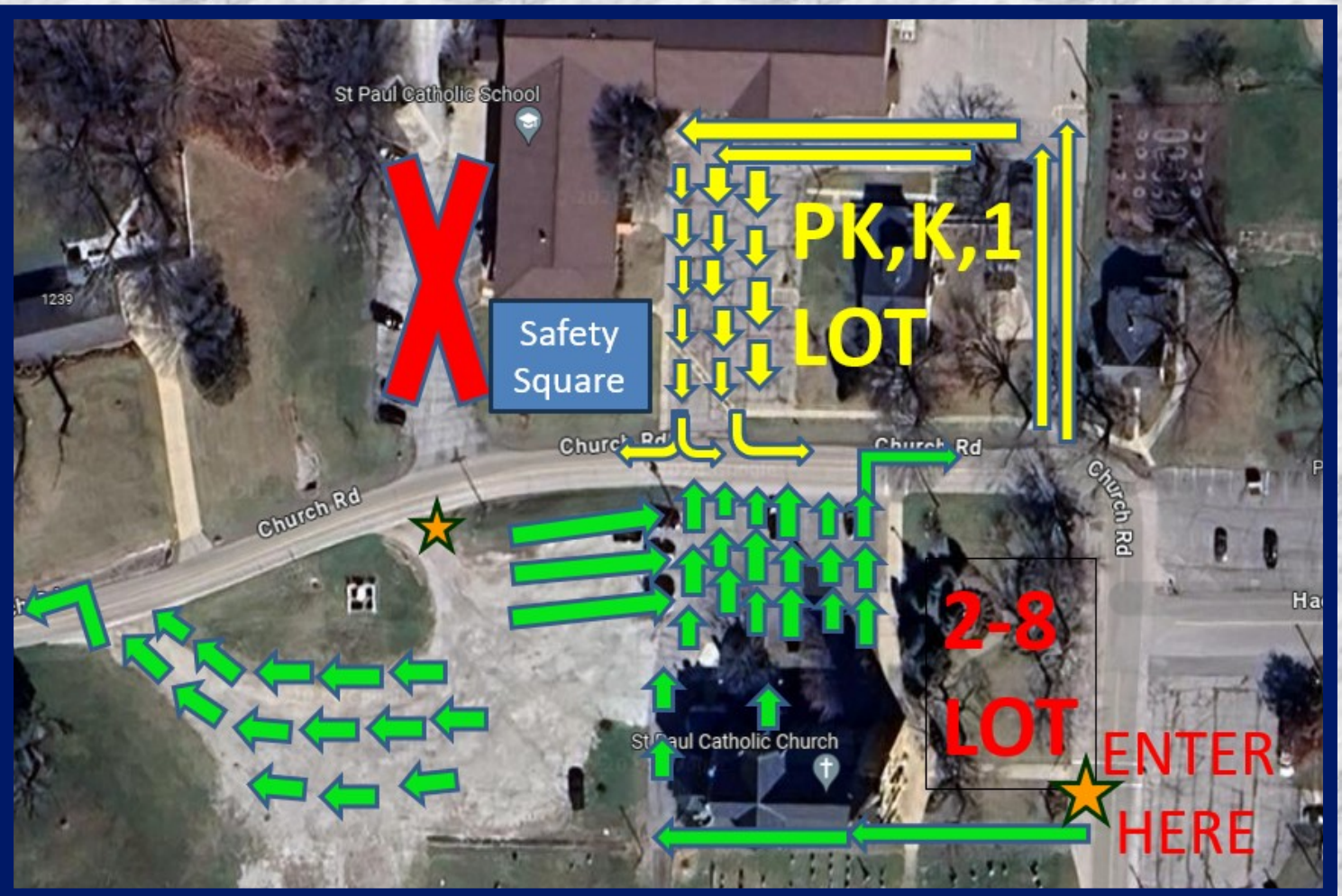

What is Meal Magic Family Portal?

Meal Magic Family Portal combines features that previously were available elsewhere but required you to visit multiple websites. Now, all food service activity can be accessed through a single site.

You can use Family Portal to view balances, see account and purchase histories, make deposits, transfer money among family members, set parental controls, apply for meal benefits, complete household information reports, and order meals. Some schools might not offer all of these features.

Registration Tips

Before registering, add *.familyportal.cloud as a safe domain email sender in your email app. If you think you did not receive an email, try looking in your spam folder. If it's there, be sure to mark it as safe for future email messages.

If you get a message about not being able to access your account, try using the **I forgot my passphrase** option under **My Account**.

Registering (Creating an Account)

Each school district has its own Family Portal web address. You will need to create an account at each one you need to access. No information is shared between districts.

Registering an account has two parts. In the first part, you will be asked to enter your email address and agree to the site's Terms of Use and Privacy Policy, after which an email will be sent to you.

Email is sent to confirm that you have access to the address you used. If you click the link that is in the email, you will be returned to Family Portal to complete the second part of registration, which entails entering your real name and setting a passphrase to protect your account.

Registrations must be completed within 20 minutes. If you take too long, you will need to click **I need to unlock my account** option.

1. Click **My Account**.
2. Click **I need to register as a Family Portal user**.
3. Enter your email address for the Username.
4. Click **Next**.
5. Read and **Accept** the Terms of Use and Privacy Policy.
6. Check your email for activation instructions.
7. Click the link in the activation email.
8. Enter your first and last name and set a passphrase.
9. Click **Submit**.

Important Note About Passphrases

A passphrase is like a password but usually is longer and has fewer restrictions on format. Your passphrase will be tested against a database of passwords known to have been compromised on other websites and will be rejected if a match is found.

For security, never use the same passphrase on more than one website, and never share your passphrase with anyone, including your district or our support team. Treat it as highly confidential.

My Account

After successfully completing registration, you will use **My Account** whenever you want to access your account.

If you have forgotten your passphrase, enter your Username and click **I forgot my passphrase**.

Adding Family Members / Pending Approvals

When logged into Family Portal, you will have the ability to add family members to your account by using the **Add Person** button. Minimally, you will need to know the ID Number assigned by the school to the person along with the person's first and last name.

Before you can access information for a person attached to your account, your school district must approve your access to them. Once approved, you will be able to see balances, settings, and histories.

Removing Family Members

To remove a family member using a smart device, swipe left on the member's name and then click the trashcan icon. On a PC, hover your mouse over the name to reveal the trashcan.

Adding Money for Family Members

When you are logged into your account, click the **Deposit** button when you want to add money for family members. Enter an amount for each person you want to give money and then click **Check-Out** to see your payment options. Click the payment method you want to use, provide the requested information, and click the **Pay** button.

Transfer Money, See History, Change Settings

Touch or click a family member on the **My Account** page if you want to transfer money from that person to another on your account, or if you want to view account history including purchases, or if you want to set parental controls (if allowed by the district).

Low-Balance Reminder Email

If you would like to receive email notifications when a family member's account balance is running low, click the **Notifications** button on the **My Account** screen. Uncheck the first box if it is checked, and then check the second box. Set a dollar amount (\$0, \$5, \$10, \$15, \$20 ... up to \$50). An email will be sent when a balance reaches or goes below the amount you set. Reminders repeat every three days as necessary.

How-To Videos

Click the **How-To Videos** button if you want to view videos about using Family Portal.

More Information and Who to Call for Help

Your information is saved with your school's private data and is not accessible by Meal Magic Corporation. Our support team cannot view your account, or any person connected to it. You must contact your school if you have questions about your family members.

Money does not flow through Meal Magic Corporation. You must contact your district about duplicate payments, refunds, or anything related to account balances. Each school district is independent of others and, therefore, is unable to transfer balances to other school districts.

For your protection, no credit card or banking information is stored by Meal Magic Family Portal.

August

FOOD IN FOCUS

Daily Specials \$3.70

Grades 5th - 8th Only

Monday: Cheese Stuffed Bosco

Stick with sauced and Fruit

Tuesday: Spicy Chicken

Patty Sandwich and Chips

Wednesday: Soft pretzel with

Cheese and Fruit

Thursday: Tony's Cheese

Pizza and Fruit

Friday: Chicken Strips and Fries

Plate Lunch Pries

Pre-School \$4.25

Grades K-2nd \$4.50

Grades 3rd-8th \$5.00

Extra Entrée \$2.00

Ala Carte Milk \$.50 / Bottled Water \$.55

Available Daily

Snack Rack & Drink Cooler

Sharon LaBarge, Cafeteria Manager

cafeteria@stpaulknights.org

Please check your Vanco RevTrak account

MENU IS SUBJECT TO CHANGE

Contact our dietitian at lisa@foodserv.org for special dietary and allergy concerns.

For more information about FSC or employment opportunities, please go to www.foodserviceconsultants.org



MONDAY

TUESDAY

WEDNESDAY

THURSDAY

FRIDAY

Did you know?

In August 1762 the sandwich, as we know it, was created when the Earl of Sandwich requested meat between two pieces of bread.

1

2

5

6

7

8

9

½ Day

No Lunch Service

Papa John's
Cheese Pizza
Orange Slices
Carrots and Celery with
Ranch Dressing

Welcome Back Special
ABC Grilled Cheese
Pencil Potatoes (Fries)
Crayons (Veggie Sticks)
Back to School Dessert
ALTERNATE
Dino Chicken Nuggets

Turkey & Cheese
Croissant
Apple Slices
Baked Chips
Mini Rice Krispies Treat
ALTERNATE
Chicken Strips

12

13

14

15

16

Mostaccioli with Meat
Sauce
Tossed Salad with
Dressing
Apple Slices
Breadstick
ALTERNATE
Toasted Beef Ravioli

19

Stadium Style Hot Dog
Tater Tots
Fresh Veggies with Dip
Creamy Sherbert
ALTERNATE
Crispy Chicken
Nuggets

20

Papa John's
Pepperoni Pizza
Grapes
Fresh Veggies with
Ranch Dressing

21

Chicken Rings
Buttered Noodles
Golden Corn
Sparkling Jell-O
ALTERNATE
Cheese Stuffed Bosco
Stick

22

BBQ Riblet Sandwich
Lay's Chips
Garden Green Beans
Chilled Peaches
ALTERNATE
Corn Dog

23

Breaded Chicken Patty
Golden French Fries
Fresh Veggies with Dip
Mandarin Oranges
ALTERNATE
Grilled Hamburger

26

Emoji Waffle
Golden Hash Browns
Tropical Fruit Medley
Mini Blueberry Muffin
ALTERNATE
French Toast Sticks

27

Papa John's
Cheese Pizza
Grapes
Fresh Carrots with
Ranch Dressing

28

Toasted Beef Ravioli
Steamed Broccoli
Breadstick
Mini Rice Krispies Treat
ALTERNATE
Chicken Rings

29

Chicken Snack Wrap
Fresh Veggies with Dip
Seasonal Fresh Fruit
Cookie
ALTERNATE
Mini Corndogs

30

St. Louis Catholic High Schools:



High School Fairs and Presentation Nights

Fall and Spring High School Fair

Showcasing All Schools 5:00 – 7:00 PM

Thursday, August 22nd

Visitation Academy

3020 N. Ballas Road, 63131

Wednesday, April 9th

Ursuline Academy

341 Sappington Road, 63122

High School Presentation Nights

Registration 6:00 – 6:30 PM

Three 20-minute school presentations 6:30 – 8:00 PM

Wednesday, September 4th

St. John Vianney

1311 S. Kirkwood Road, 63122

Tuesday, September 17

St. Dominic High School

31 St. Dominic Drive, 63366

Monday, September 30th

Cor Jesu Academy

10230 Gravois Boulevard, 63123

Thursday, October 10th

St. Mary's South Side Catholic

4701 South Grand Boulevard, 63111

Families select which presentations to attend. All students in grades 5-8 are welcome. Families may attend any of the high school nights.

**We look forward to seeing you on campus this fall at
Cor Jesu Academy!**

Registration opens for ALL fall events on August 1 at 9 am. at corjesu.org/visit!



UPCOMING EVENTS



8TH GRADE SHADOW DAYS

See how you can SHINE BRIGHT at Cor Jesu Academy! A Shadow Day at CJA includes a tour of our beautiful campus, a visit to three dynamic classes and a yummy lunch from our cafeteria. We have eight reserved days throughout the fall for our 8th graders to SHINE.



COR JESU NIGHT

Want to learn about all things CJA? Join us on **Tuesday, September 17** for Cor Jesu Night! Hear from current CJA students, visit campus and attend 20-minute breakout sessions on topics of your choice from mythbusters, career prep, traditions and more.



HIGH SCHOOL NIGHTS

We invite girls in grades 5-8 and their families to meet Cor Jesu students at high school nights. Learn, from their perspectives, how they SHINE at CJA through faith and spirituality, academics, fine arts, co-curriculars, athletics and more.



OPEN HOUSE

Join us for Cor Jesu Academy's annual Open House! We look forward to welcoming middle school families to campus on **Sunday, October 27**. In addition to your one-on-one tour of campus, you will have the opportunity to meet CJA faculty and staff, and learn how we SHINE together at Cor Jesu.

Registration opens for ALL fall events on August 1 at 9 a.m. at corjesu.org/visit!

Olivia Hanford

Olivia Hanford '17
Director of Admissions
ohanford@corjesu.org

Julie Flatley Dame

Julie Flatley Dame '94
Admissions Coordinator
jdame@corjesu.org

Katherine P. Martin

Katie Martin
Admissions Assistant
kmartin@corjesu.org